

RAUMPLUS – BOUNDLESS COMFORT



raumplus

SPACE WHICH IS JUST RIGHT FOR ME_ LIVING COMFORT FOR ANY LIFE SITUATION

raumplus fulfils ...

... your wish for living comfort which also meets the changing demands in the course of life. Thus, we guarantee that sustainability – as is the case in other areas – applies to the living area as well. Accessibility is a clear sign of properly and cleverly thought-out architecture and design: Sufficient area to move, avoidance of steps and thresholds as well as adaptability concerning height and depth. With **raumplus** you turn the lightness of being in your own four walls into a principle of life.

We at **raumplus** believe ...

... that good furnishing and living solutions should always perfectly harmonize with their users. For this reason we have been developing room dividers and closet systems on the basis of the sliding door principle being flexible and adaptable. Our built-in solutions are tailor-made according to your wishes – matching your personal style of living.

Try the possibilities of **raumplus**! We are looking forward to you.



ROOM DIVIDER WITH INSERT BOTTOM TRACK_
 OPTIONALLY FLUID TRANSITION AND CLEAR SEPARATION



1_



2_



3_

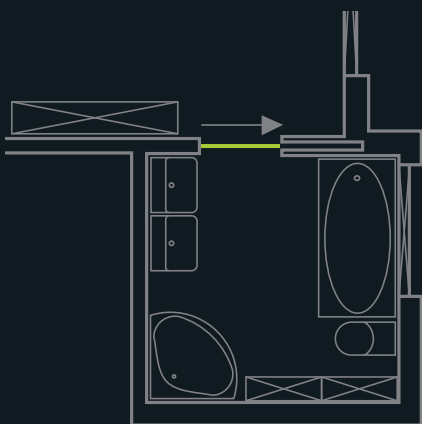

Concerning the floor-supported sliding door variant the **raumplus** bottom tracks are preferably inserted into the floor. Thus, they are not only as decent as possible but above all tread-friendly.

If you like to use double doors, then our synchronous drive offers an additional ease in everyday life: the doors slide synchronously – if one is moved, both move. In addition, a motor can be installed supporting the opening of the doors. A special

detail in this furnishing: Here the sliding door disappears in the wall saving space – the so-called pocket door variant.

1/2_ Profile system_ S3000

Frame_ silver anodized

Panel_ laminated safety glass with colored foil

3_ Detail_ Bottom track insert, as visual divider for the different floor coverings

ROOM DIVIDER WITHOUT BOTTOM TRACK («AIR« SYSTEM)_ WITH SENSOR AND MOTOR DRIVE



1_

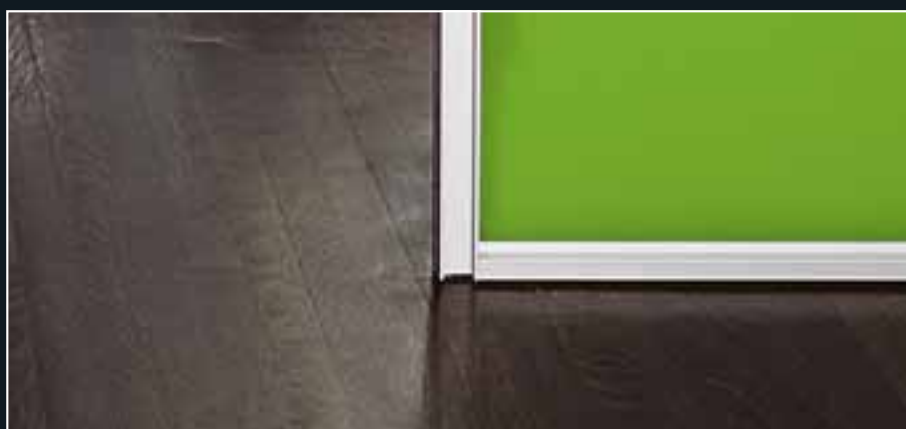

2_



The »AIR« system completely goes without using bottom tracks. Consequently, the floor designing remains untouched. Being equipped with a movement sensor and a motor drive, the opening and closing can be regulated automatically thus increasing the free movement in any life situation. Through the flexible measurements for height and width **raumplus** sliding doors are perfectly suitable for accessible living spaces as well. At **raumplus**, a door of 1.20m height, for example, is regarded

as standard, not as special solution. This is also advantageous with regard to design: for extra-wide formats make an elegant and spacious impression in every apartment.

1_ Profile system_ S3000, »AIR« system

Frame_ silver anodized

Panel_ laminated safety glass with colored foil

2_ Detail_ sliding door on universal parquet floor without bottom track

WALK-IN CLOSET WITHOUT BOTTOM TRACK («AIR« SYSTEM)_

THE ROOM IN ROOM WITH A LOT OF DESIGNING FLEXIBILITY



1_

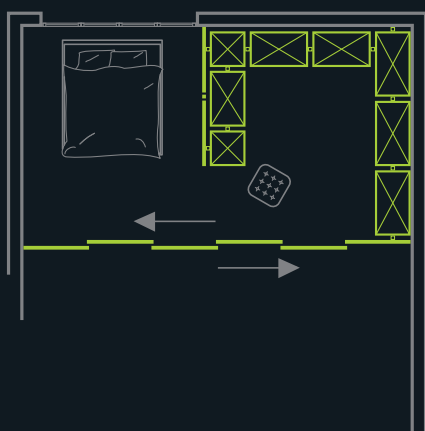

2_

Walk-in closets with **raumplus** interior systems combine spaciousness with perfect details. For your individual living comfort the interior systems are made to measure and offer practical functions which can be combined with each other just as you like. Through their special construction all elements can be put smoothly in the desired handle height completely meeting your wishes and needs.

And this functions both on the small and large scale: In the combination of sliding doors and partitioning walls new rooms



3_

can easily be designed – your living space adapts to your desires.

1_ Profile system_ S3000

Frame_ silver anodized

Panel_ laminated safety glass with matte foil

Interior system_ Uno, decor white, as corner solution

2_ Interior system_ Uno, detail_ shelf attachment

3_ Interior system_ Uno, detail_ drawer element

INTERIOR SYSTEMS FOR BUILT-IN CLOSETS_

THE BIG RANGE INCLUDING ECOLINE, LEGNO, UNO AND CORNICE



1_



2_

The interior systems of **raumplus** make a contribution! Each system offers many practical functions which can be varied and expanded just as you like. The quality claims of **raumplus** reach the smallest tricks with which the system brings comfort in your everyday life: height-adjustable shelves, pull-out shelves for shoes, drawers opening on little pressure, coat hangers which can be pulled out from the shelf according to demand.



3_

1_ System_ C42

Frame_ Polyrey laminate covered with veneer, natural, old walnut

Interior system_ Ecoline, decor white

2_ Interior system_ Uno, detail clothes hanger bracket

3_ Interior system_ Cornice, detail pull-out roller carriage for shoes



SUSTAINABLE LIVING – A LIFETIME_

AT THE DFKI TOGETHER WITH RAUMPLUS THE FUTURE OF LIVING IS DEVELOPED



1_



2_



3_

1–3_ On these and the following pages you see apartment rooms of the BAALL (Bremen Ambient Assisted Living Lab), a living space simulation for accessible living. In this 1:1 test room scientists of the DFKI develop solutions for living and residing facing limited life situations on the basis of the most different technologies and the support of well-known manufacturers.

The BAALL was designed and built in cooperation with the University of Bremen in the EU project Share-it as well as in the SFB/TR8 Spatial Cognition of the German Research Foundation (DFG, Deutsche Forschungsgemeinschaft).

As a manufacturer of innovative furnishing systems **raumplus** works closely together with research institutions, both with regard to design – e. g. with the Designlabor Bremerhaven – and regarding functionality. Currently, **raumplus** supports the research activities of the German Research Center for Artificial Intelligence GmbH (DFKI / Deutsches Forschungszentrum für Künstliche Intelligenz), at its Bremen site. Conducted by Professor Dr. Bernd Krieg-Brückner a lot of possibilities are developed here which allow leading the life as autonomous as possible even with limited physical functions. This already commences with the avoidance of stumbling thresholds and the comfortable proportioning of extra-wide room openings along with doors, implies the automation of doors and ends not by any means with voice-controlled personal mobility assistants with individual surround sensor technology.

LIVING LAB AT THE DFKI – ROOM DIVIDERS IN THE LIVING AREA_

WITHOUT BOTTOM TRACK / AUTOMATIC OPENING



1_



2_

1/2_ Profile system_ S1500, with »AIR« system, without bottom tracks
Frame_ silver anodized
Panel_ decor maple
Automatic mechanism_ automatic opening and closing after a little push, with magnetic induction in the top track

10_11

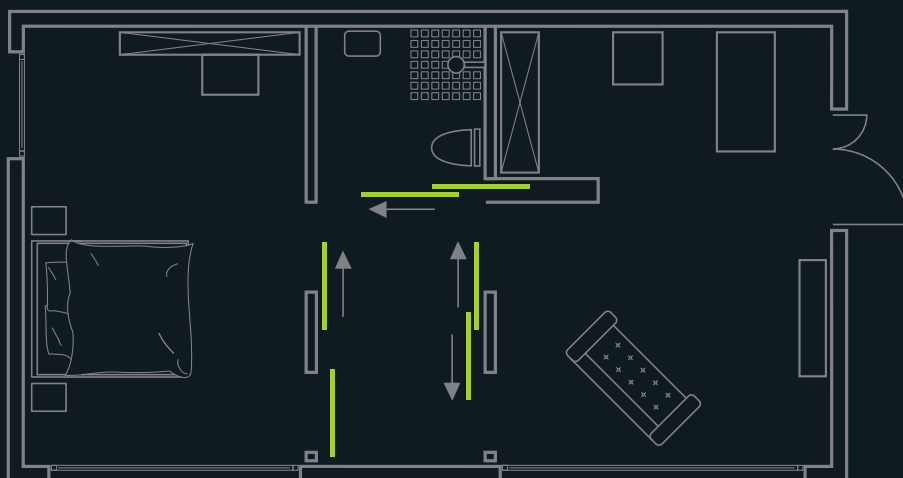

LIVING LAB AT THE DFKI – SPACIOUS ROOM OPENING IN SANITARY AREA_
WITH INSERT BOTTOM TRACK / AUTOMATIC OPENING



1_

Extremely comfortable and open and nevertheless discreet: Accessible furnishings face the biggest challenges in the sanitary field. Here the necessity of maximal freedom of movement meets the wish for dissociation and intimacy. Thanks to the absolutely flexible room dividers of **raumplus** rooms are made optimally accessible and even form new combinations and consequently new units to be used – in this case the bathroom and the interim hall (optionally useable as storage space).



2_

The **raumplus** products take on a crucial function in the Living Lab apartment when it comes to room designing and decoration. Especially thanks to their flexibility they even meet the highest demands of the researchers. Over and above that, **raumplus** obviously brings in its key competence »design« in the results of the DFKI project.



3_

1–3_ Profile system_ S1500, with 100 % door opening – the doors »disappear« in the wall covering (pocket door)

Frame_ silver anodized

Panel_ decor maple

Automatic mechanism_ optional with movement sensor

RAUMPLUS FOR UNLIMITED FREEDOM



1_

1_ No steps and thresholds. With its sliding doors **raumplus** offers a practical advantage: no steps – no stumbling traps!



2_

The doors slide smoothly in the bottom and top guide. The flat bottom track is inserted into the floor covering.

2_ As an alternative the »AIR« system completely manages without a floor-supported guide and lets the floor untouched.



3_

3_ The DFKI is located in the »Cartesium« building of the University of Bremen, Technology Park Bremen

RAUMPLUS AND THE RESEARCH OF THE DFKI

raumplus supports the research activities of the German Research Center for Artificial Intelligence (DFKI) in the field of accessible living. The results of the DFKI research are utilized – among others – by user associations and clinics and are reviewed with respect to suitability for everyday life.

If you are interested in the research of the DFKI in the field of »Ambient Assisted Living«, you will find a lot of further information and all contact details at www.dfki-bremen.de in the section »Safe and Secure Cognitive Systems« of Mr. Professor Dr. Krieg-Brückner and his team, as well as at www.baall.net.